

Crowne Plaza Newcastle
Newcastle, NSW, Australia

A Business Proposal

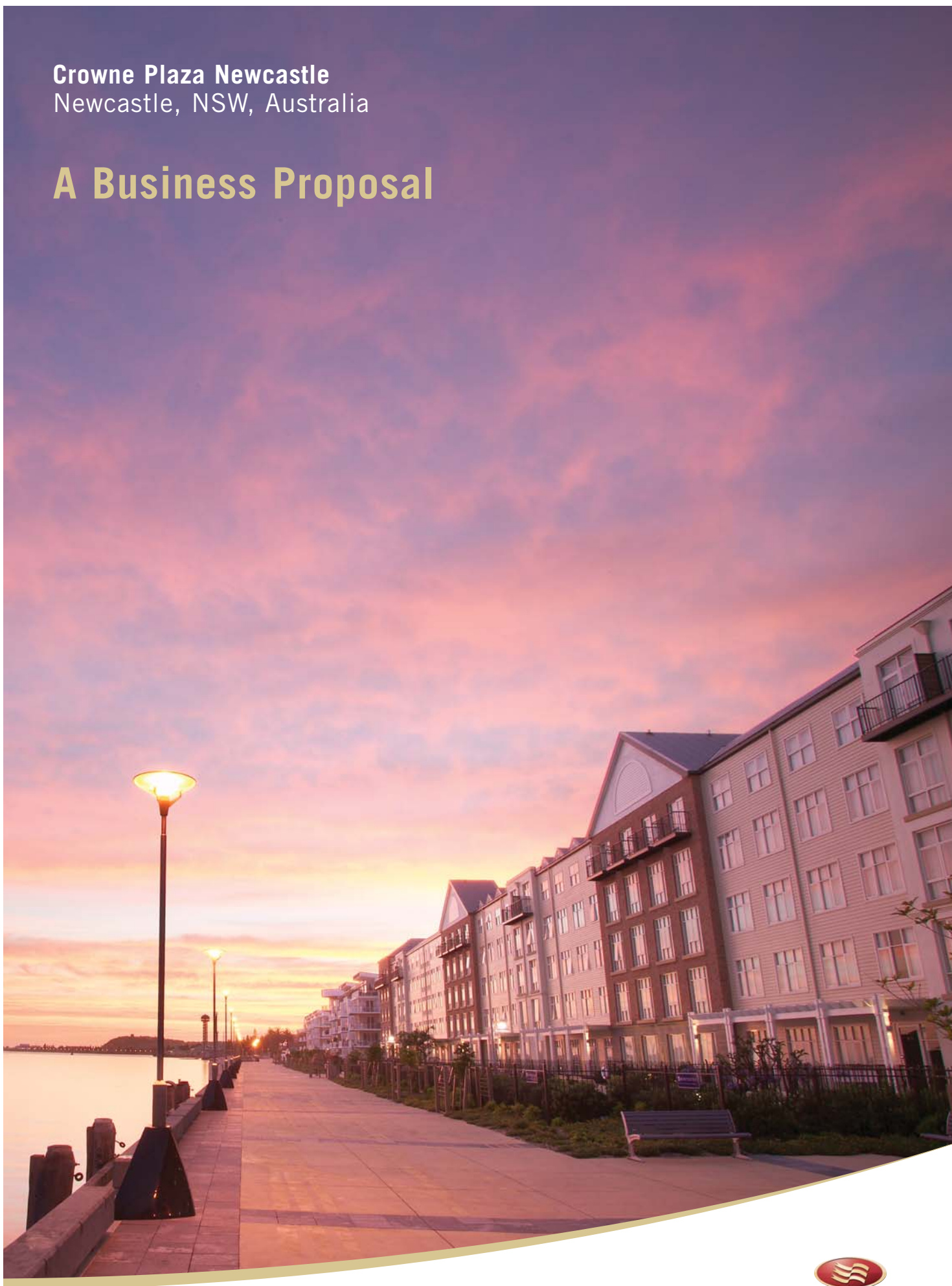

CROWNE PLAZA

NEWCASTLE

THE PLACE TO MEET.

Executive Summary

Crowne Plaza Newcastle is *The Place To Meet* for meetings, launches and presentations. The hotel is located directly on the Newcastle harbourfront within minutes walk of the central business district, 2 hours drive north of Sydney and only 20 minutes from Newcastle Airport.

The meeting facilities are designed for maximum functionality. Soundproofing, room colour selection and audio-visual options, for example, have been created to allow meeting planners and conference attendees to focus on business objectives. Innovative meeting set ups, flexible dining options, extensive local area activities, and the dedicated Crowne Meetings Director are services that will make your meeting a success.

Successful Meetings

Because meetings are an imperative part of business, we have put together a comprehensive range of products and services called *Meeting Success™*. With a team that understands your needs, Crowne Plaza Newcastle is committed to helping you make a success of any meeting.



- Your personal *Crowne Meetings Director* who will assist you with all aspects of your meeting from planing through to execution, leaving you free to achieve your meetings goal's.
- A 2-hour response to all meeting enquiries, followed by a detailed proposal in 24 hours, is guaranteed.
- A *Daily Meeting Debrief* to help you stay on top of things, reviewing meeting progress, feedback on any changes and ensures prompt actions are taken.
- *Handy Meeting Kit* containing essential stationery items such highlighter pens and post it notes.
- Distinctive meeting room innovations including a coat rack, facilitator stool and aromatherapy burner.
- Choice of meeting rooms and boardrooms. Please see overleaf for specifications.
- As your time is valuable, express check-in and check-out services are available.
- *Meet & Eat* menu offering snacks, stationery and business services you can use anywhere within the hotel for informal meetings.
- *Snack Attack* for a continuous supply of brain food during a meeting.

- *Lunching In* designed to provide a menu that is contemporary and tasty, yet able to be served without disturbing the flow of the meeting.
- On-site audio visual experts ensure you receive the latest technical support, including internet access in all meeting rooms, video-conferencing capabilities and laptop presentation service.

A Complete Home Office

While staying at Crowne Plaza Newcastle we understand business must continue so we offer the tools to help you succeed. Just think of us as an extension to your office. Each of the 175 one-bedroom guest suites, including 38 Executive Floor suites, offer:

- Separate living area containing large desk with handy data ports and work lamp
- High speed internet and dual modem connection
- IDD lines and voicemail
- Free cable TV channels
- In-room Safe Deposit to hold laptops
- Lengthy Stay Program providing at home conveniences such as a microwave
- In-room coffee and tea making facilities
- Access to a fully equipped business centre
- Suites modified for disabled access
- Central air-conditioning with individual climate control
- All day self service tea and coffee available in the Executive Floor Lounge



Where to Eat

Using a fresh approach to cuisine based around the celebrated Hunter produce, Crowne Plaza Newcastle delivers innovative and exciting delegate dining. Create interest by selecting from the flexible dining locations including the range of meeting rooms and outdoor harbourside options.



- **Morning and Afternoon Tea Options**

Delegates will be completely refreshed and enthused after enjoying some of the specialty coffee breaks served on the Harbour Terrace.

- **Gourmet Lunch Options**

A selection of seasonal menus and locations offer a variety of choice for lunch including take away options to enjoy by the pool or harbourside.

- **Event Dinners**

Enjoy the flexibility of creating your own menu from the wide selection of dishes utilising fresh local produce. Create a major impact by choosing one of the many themed room designs.

- **Breeze Restaurant and Bar**

As a refreshing change for your delegates, enjoy a glass of Hunter Valley wine and experience an inspired menu combined with fascinating harbour views.



Tips for Relaxation

For relaxation or to re-energise delegates our Crowne Meetings Director suggests the following incentives:

- **Moonshadow Cruises**

Relax as you cruise the ever-changing waterways of Newcastle Harbour. Cruise charters available between November and May.

- **Honeysuckle Markets**

Indulge in private produce tastings accompanied by Hunter Valley wines in the Honeysuckle Markets heritage building.

- **Sea Kayaking**

Paddle past the hotel and Newcastle's foreshore to arrive at Horseshoe Beach for a relaxing picnic lunch.

- **Newcastle's Famous Tram**

Experience the history of Australia's second oldest city with Newcastle's Famous Tram. Tours collect delegates from the hotel.

- **Get Fit**

Refresh in the 25-metre outdoor pool set in private, landscaped grounds on the harbour's edge. Add an invigorating workout in the fully equipped gym neighbouring the hotel to your delegates' day.

- **Peddle Power**

Discover the 6km of waterside paths with full day bike hire. Enjoy refreshments along the way or combine with a swim at one of Newcastle's pristine beaches or ocean baths.



Hotel Plan

With all meeting rooms located on the Crowne Plaza Newcastle ground floor, easy access is available for delegates to adjourn to break out sessions in secondary meeting areas and meet for a drink in Breeze Bar. To take a breath of air, step from the hotel lobby direct on to the Newcastle harbour foreshore. Select the hotel's poolside Harbour Terrace for a morning or afternoon break; convenient and refreshing.

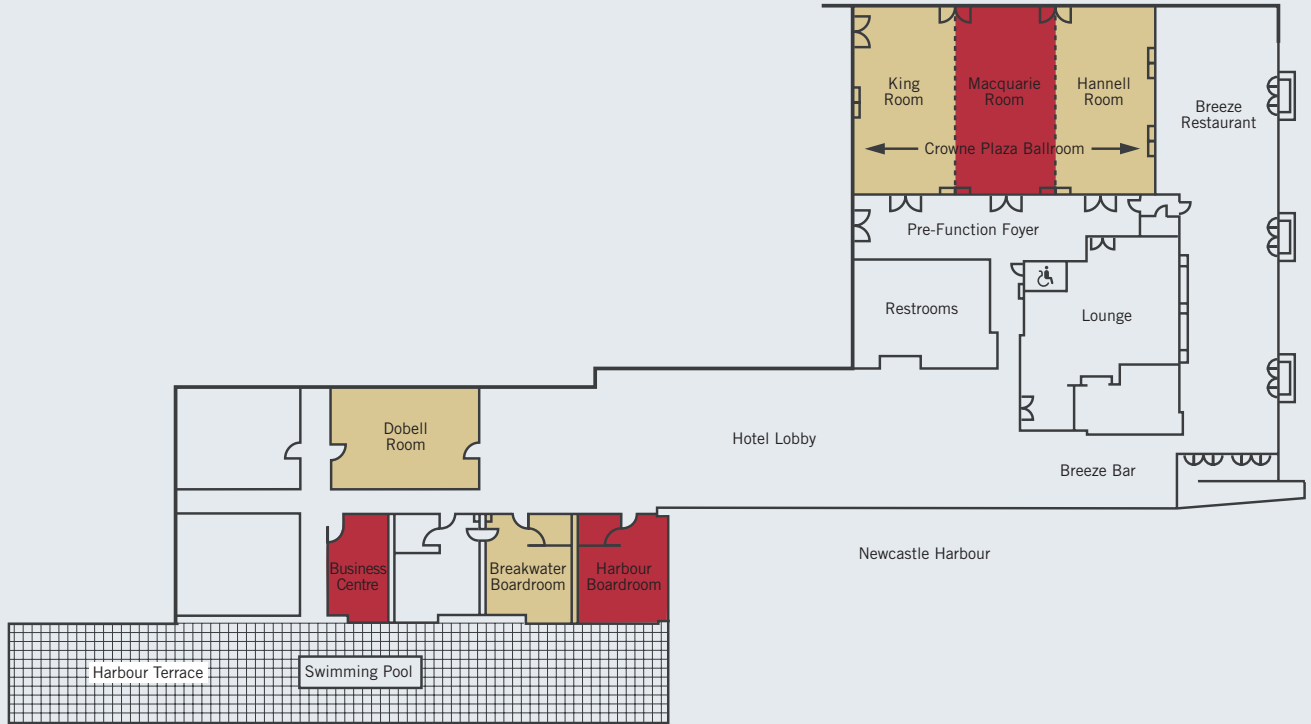

Meeting Room Specifications

ROOM	DIMENSIONS	FLOOR AREA m ²	CEILING HEIGHT m	DOOR	CLASSROOM	THEATRE	BANQUET	BOARDROOM	COCKTAIL	U-SHAPE
Hannell Room	11.0m x 6.0m	66	3	W 1.44m H 2.25m	24	60	40	28	55	24
Macquarie Room	11.0m x 6.0m	66	3	W 1.44m H 2.25m	24	60	40	28	55	24
King Room	11.0m x 6.0m	66	3	W 1.44m H 2.25m	24	60	40	28	55	24
Macquarie / Hannell	11.0m x 12.0m	132	3	W 1.44m H 2.25m	48	150	90	-	120	35
King / Macquarie	11.0m x 12.0m	132	3	W 1.44m H 2.25m	48	150	90	-	120	35
Crowne Plaza Ballroom	11.0m x 18.0m	200	3	W 1.44m H 2.25m	72	240	160	-	220	-
Crowne Plaza Ballroom with Dance Floor	11.0m x 18.0m	-	3	-	-	-	130	-	-	-
Pre Function Foyer	18.0m x 3.0m	68	3	-	-	-	-	-	-	-
Dobell Room	5.0m x 12.0m	60	2.7	W 0.84m H 2.23m	20	40	30	21	40	21
Harbour Boardroom	4.0m x 5.0m	20	2.7	W 0.84m H 2.23m	-	-	10	10	-	-
Breakwater Boardroom	4.0m x 5.0m	20	2.7	W 0.84m H 2.23m	-	-	10	10	-	-
Harbour Terrace	-	-	Outdoor	-	-	-	-	-	200	-

Crowne Plaza Ballroom

The Crowne Plaza Ballroom, linked to the Newcastle harbour foreshore promenade via the lobby, accommodates up to 160 guests banquet style and can divide into 3 smaller rooms. As individual rooms, the King Room, Macquarie Room and Hannell Room, each cater for approximately 40 guests banquet style. The Crowne Plaza Ballroom offers access large enough for a car making it suitable for major launch events.

Dobell Room

For break-out sessions or smaller group meetings, the Dobell Room offers natural light and theatre-style seating for 40 delegates. Located off the hotel lobby, this meeting room is handy to the Business Centre, Harbour Terrace and Breeze Restaurant.

Harbour Boardroom and Breakwater Boardroom

Ideal for intimate boardroom style meetings, the Harbour and Breakwater Boardrooms are located on the ground floor with windows looking across the Harbour Terrace to Newcastle's working port. Accommodating 10 people boardroom style, the meeting rooms also offer the perfect location for a private dinner.

Harbour Terrace

With Nobby's Lighthouse and the Newcastle working harbour a backdrop, the Harbour Terrace creates a unique environment for a daytime launch event, themed lunches and breaks, pre-dinner cocktails, and press conferences. The landscaped gardens and grassed area border the 25 metre swimming pool and foreshore promenade.

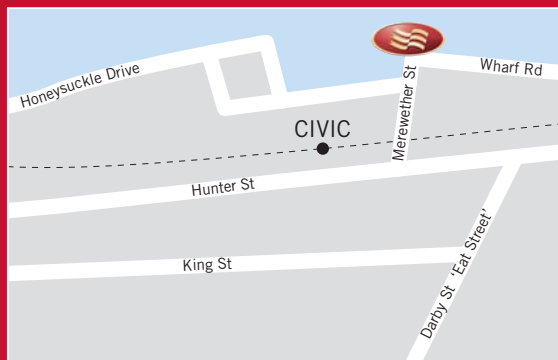

The hotel is only 20 minutes by car from Newcastle. Coach transfers are available from Newcastle Airport.

If driving, take the Wallsend exit off the F3 and follow signs to the city centre. Turn left at Union Street, right at Hunter Street, then left into Merewether Street.

The closest train station to the hotel is Civic Station. On exiting the station, turn left into Merewether Street, the hotel is a 100-metre walk.



CROWNE PLAZA®

NEWCASTLE

THE PLACE TO MEET.

Crowne Plaza Newcastle

Cnr Merewether Street & Wharf Road,

PO Box 411, Newcastle NSW 2300

Tel: +61 (0)2 4907 5000

Fax: +61 (0)2 4907 5055

Email: meetings.crowneplazanewcastle@ihg.com

Website: www.crowneplaza.com.au

Reservation Toll-free Number: (Australia) 138 388,

(New Zealand) 0800 801 111 and in other countries +61 (0)2 9935 8313