



## Location

Within walking distance of the city centre and Launceston's vibrant, colourful Seaport. The Sebel Launceston is located in the heart of one of Australia's oldest cities featuring historic buildings dating back to the Georgian era.  
Distance from the airport: 15kms.

## Distinctive features

The Sebel Launceston is an elegant, European style, boutique hotel that showcases the use of natural Tasmanian stone and timbers throughout the interior and courtyard. All guestrooms are spacious and stylishly appointed.

## Accommodation

49 fully self-contained 1 and 2 bedroom suites with separate bedrooms and bathrooms. Many suites feature a spa bath or laundry.

## Suite features

- Spacious with superior appointments
- Separate bedrooms and bathrooms
- Fully self-contained with microwave and hotplates
- King size beds
- Balconies
- Spa baths available in a number of suites
- Tea and coffee making facilities
- In-room movies
- In-suite laundry in many suites (washing machine, dryer, iron and ironing board)

## Suite facilities

- Widescreen TV
- DVD and sound system
- High speed broadband access
- Individually controlled air-conditioning
- In-room, laptop size safe
- ISDN/STD telephone
- Alarm clock/radio
- Mini bar

## Guest services

- 24-hour room service
- 24-hour reception and concierge
- Daily housekeeping service
- Valet dry-cleaning and laundry (weekdays)
- Car parking
- Wireless hotspots in the foyer and restaurant

## Suite layouts

1 bedroom deluxe suite  
average size: 45m<sup>2</sup>



2 bedroom deluxe suite  
average size: 90m<sup>2</sup>



## Meeting and event facilities

The Sebel Launceston offers elegant meetings, conferences, cocktail parties and wedding celebrations for up to 50 delegates or 60 guests for cocktails. A flexible meeting room offers state-of-the-art audio-visual equipment and wireless technology. A delightful guest courtyard is ideal for outside dining or as a breakout area. The spacious guest lounge with open fire place is perfect for morning or afternoon tea breaks and pre-dinner drinks.

## Services

- Meeting and function planning service
- Overhead projector and screen
- Wireless technology
- Whiteboard
- Flipchart
- TV and video
- Pads, pens, iced water and mints on table
- Additional audio-visual equipment and presentation aids available on request

## Conference room layouts

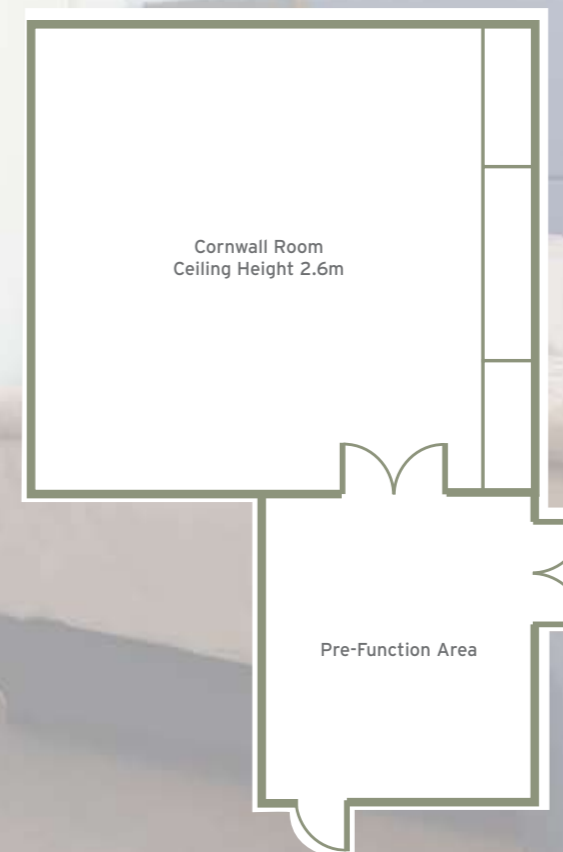

## Conference room capacities

VENUE	CABARET	THEATRE	CLASSROOM	U-SHAPE	BOARDROOM	DINING	COCKTAIL	AREA METRES SQ
Cornwall Room	40	50	33	27	40*	20	60	72
Foyer Lounge	-	-	-	-	-	-	20	-
Foyer Courtyard	-	-	-	-	-	25	20	-
Restaurant	-	-	-	-	20	45	60	-

\*utilising 2 tables



## Restaurant and bar

**Market Square Restaurant and Bar** serves fresh, local seafood and excellent culinary delights created from an abundance of seasonal produce, complemented by an extensive choice of award-winning Tasmanian wines.

## Recreation and fitness

- Private courtyard framed by Oak Trees
- Exercise room

## Nearby attractions

- Tamar Valley - Tasmania's premier wine growing region
- Queen Victoria Museum and Art Gallery
- Inveresk Precinct - Art Gallery and Museum
- Civic Square
- City Park
- The Gorge - historic parks and walking trails
- Boag's Brewery
- Aurora Stadium
- Woolmers and Clarendon House - historic homesteads
- Aquarius Roman Baths
- Tamar River Cruises
- Tasmania's rugged, ancient beauty inspires adventure, unparalleled in Australia



[www.mirvachotels.com](http://www.mirvachotels.com)

managed by Mirvac Hotels & Resorts

