

THE SEBEL



LAUNCESTON

Cnr St John & William Streets Launceston TAS 7250

P +61 3 6333 7555 – F +61 3 6333 7559

E events@tsl.mirvac.com

W www.mirvacotels.com

conference

welcome | services & facilities | day packages | breaks | breakfast | lunch & dinner | cocktail | beverages | gallery



welcome



conference

welcome | services & facilities | day packages | breaks | breakfast | lunch & dinner | cocktail | beverages | gallery

The Sebel Launceston

Launceston's most modern all-suite hotel, The Sebel Launceston is a European-inspired boutique hotel located in the heart of town, just 2 minutes walk from the CBD, the Seaport dining precinct and all major attractions. Combining boutique elegance with style and convenience, all-suite accommodation comprises 51 fully self-contained, spacious one, two, three and four bedroom suites, all with private balcony, separate bedroom with luxurious King size beds and stunning bathrooms, many featuring spa bath or laundry facilities. Showcasing natural Tasmanian stone and timbers throughout the interior and locally commissioned art, the hotel offers charming, contemporary accommodation and unrivalled service in one of Australia's oldest and most picturesque cities.



THE SEBEL



LAUNCESTON

Cnr St John & William Streets Launceston TAS 7250

P +61 3 6333 7555 – F +61 3 6333 7559

E events@tsl.mirvac.com

W www.mirvac-hotels.com

conference

welcome | **services & facilities** | day packages | breaks | breakfast | lunch & dinner | cocktail | beverages | gallery

services & facilities



next 



conference

welcome | **services & facilities** | day packages | breaks | breakfast | lunch & dinner | cocktail | beverages | gallery

Whether you are looking for Launceston conference venues, meeting rooms or function facilities, we have the location for you...seminars, elegant cocktail receptions, product launches, incentive events or VIP dinners...all can be accommodated at

The Sebel Launceston

The Sebel Launceston offers a range of well appointed variable space meeting rooms. Featuring state of the are audio visual equipment, we have a space that has floor to ceiling windows with spectacular views of the Tamar River and the hills to the west of Launceston, to our main conference room providing complete black out of light ideal for presentations.





conference

welcome | **services & facilities** | day packages | breaks | breakfast | lunch & dinner | cocktail | beverages | gallery

Arrival and Departure

Check In Time – from 2.00 pm

Check Out Time – before 11.00 am

Early check in or Late check out can be arranged on request and may incur an additional charge.

Market Square Restaurant & Bar

Serving an extensive buffet breakfast from 7:00am – 10.30am seven days a week. A la Carte lunch and dinner Mon-Sat. Light snacks are available throughout the day.

Room Service

Available 24 hours, 7 days a week.

Business Centre

Available 24 hours – services include high speed internet access, courier and photocopying.

Concierge

Our Concierge Team will be happy to assist you with local attraction information, tour bookings and dining recommendations as well as baggage handling, taxis and other special requests.

The Workout Room

Located on the second floor and equipped with a full range of the latest exercise equipment.

Air Conditioning

All rooms and suites are equipped with individual cooling, heating and fan controls.

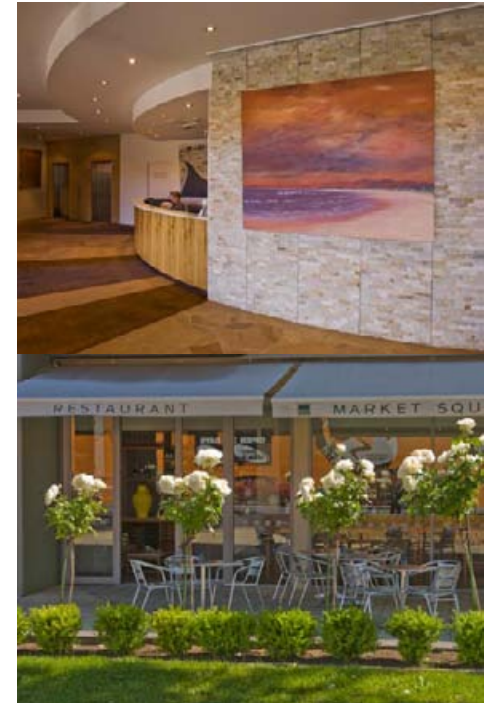



conference

welcome | **services & facilities** | day packages | breaks | breakfast | lunch & dinner | cocktail | beverages | gallery



Parking and Vehicles

Street parking is available surrounding the hotel, or guests may self-park at the local parking station at the 'Spotlight centre' on William St. Limited parking is available within the hotel at \$7 per car.

Please obtain a parking permit from hotel reception.

Credit Cards

We accept all major credit cards – Visa, Mastercard, American Express, Diners and JCB.

Internet Access

High speed internet access is available in all guest rooms and wireless internet access is available in public areas of the hotel and in all conference areas.

In Room Safe

All guest rooms and suites have a programmable laptop sized in room safe.

Cornwall suite

Our Cornwall Suite conference room is located on level 2 of The Sebel Launceston. With a capacity for up to 50 people this suite is ideal for conferences, meetings, seminars, product launches and cocktail functions. The Cornwall Suite pre-function area is perfect for morning and afternoon tea breaks, working lunches and post function drinks and canapés. Our Lobby Lounge & Courtyard is ideal as an alternate venue.





conference

welcome | **services & facilities** | day packages | breaks | breakfast | lunch & dinner | cocktail | beverages | gallery

Boardroom

The Boardroom is your perfect choice for smaller meetings, seminars, interviews and retreats. This private meeting room also features a small breakout lounge and adjacent private balcony overlooking Launceston.

The Penthouse

With floor to ceiling windows and balcony with spectacular views of the Tamar River and the hills to the west of Launceston, the Penthouse is ideal for breakfast meetings, cocktail parties, product launches and meetings. The area features a large space with adjoining private kitchen. With four bedrooms available that can be converted to breakout or small meeting rooms available, this could be the ideal area for your conference.

Private suite

Our more intimate Two Bedroom Suites boast natural light, generous and flexible lounge area and private exterior balcony, making an ideal space for smaller events such as fashion showings, board meetings, private dinners and cocktail parties.

Market Square Restaurant & Bar

Market Square restaurant & bar is available for group breakfasts, lunches or dinners and other functions and special occasions. The adjacent Market Square Terrace provides a flexible outdoor-dining option perfect for cocktail parties, summer drinks or al fresco dining (weather permitting).





conference

welcome | **services & facilities** | day packages | breaks | breakfast | lunch & dinner | cocktail | beverages | gallery

Maximum capacities may vary subject to audio visual, stage and theming requirements.
NR – Not Recommended

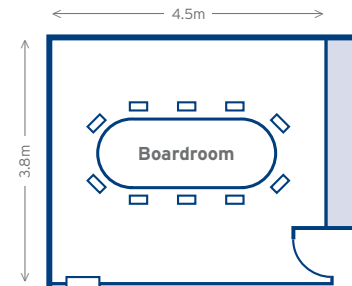
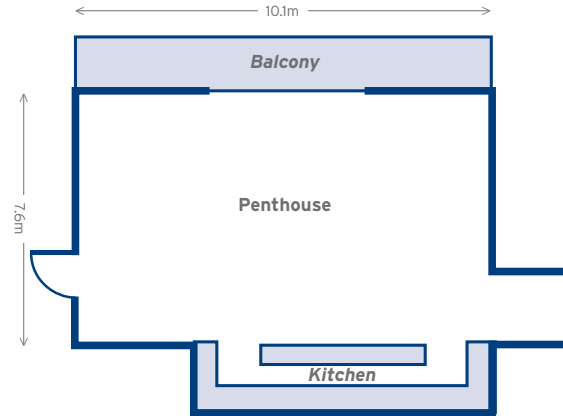
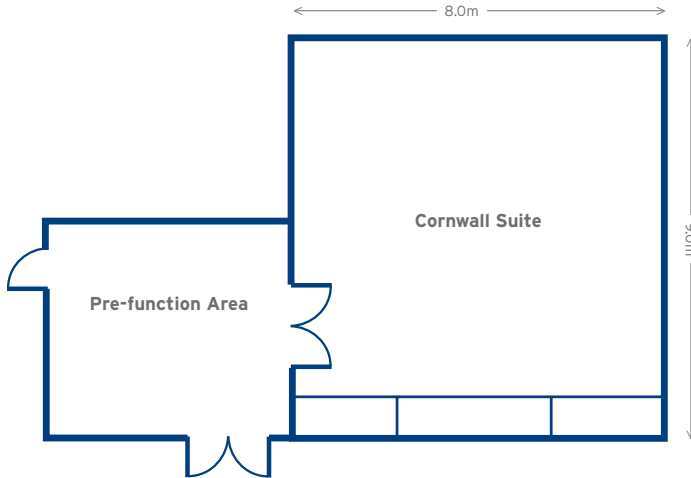

	Theatre	Hollow Square	Board Room	U-Shape	Class Room	Cocktail	Cabaret	Dinner Dance	Dining	Area m ²	Ceiling height
Cornwell Suite	50	20	40	25	36	60	40	NR	30	72	2.6
Boardroom	NR	NR	8	NR	NR	15	NR	NR	10	17	2.7
Penthouse	36	20	20	NR	24	60	24	NR	20	180	2.4
Two Bedroom Suite	25	NR	20	NR	18	30	NR	NR	16	90	2.7
Restaurant	20	NR	12	NR	NR	100	50	NR	50	100	3.3
Outdoor Terrace	NR	NR	NR	NR	NR	100	50	NR	50	67	—
Lobby Lounge & Courtyard	NR	NR	NR	NR	NR	50	NR	NR	25	50	3.3



THE SEBEL



LAUNCESTON

Cnr St John & William Streets Launceston TAS 7250

P +61 3 6333 7555 - F +61 3 6333 7559

E events@tsl.mirvac.com

W www.mirvacotels.com

conference

welcome | services & facilities | **day packages** | breaks | breakfast | lunch & dinner | cocktail | beverages | gallery

day packages

full day delegate package

half day delegate package

breakfast meeting packages

room hire | additions



conference

welcome | services & facilities | **day packages** | breaks | breakfast | lunch & dinner | cocktail | beverages | gallery

Prices are subject to change without notice. Prices displayed are GST-inclusive.

full day delegate package

\$65 per person per day*

Welcome signage

Conference room hire (8.00am – 5.00pm)

Nespresso coffee, a selection of teas and orange juice on arrival

Your selection of our morning and afternoon tea specialty breaks menu

Your selection of working style lunch served with freshly brewed coffee and teas

Iced water, notepads, pens and sweet selection

Standard audio visual equipment including screen, non-electronic whiteboard/flipchart with markers

Complimentary parking for the group organiser (1 parking space)



* Minimum spend per conference room applies, otherwise a room hire applies.

conference

welcome | services & facilities | **day packages** | breaks | breakfast | lunch & dinner | cocktail | beverages | gallery

Prices are subject to change without notice. Prices displayed are GST-inclusive.

half day delegate package

\$50 per person per day*

Welcome signage

Conference room hire (8.00am – 12.00pm or 1.00pm – 5.00pm)

Your selection of our morning or afternoon tea specialty breaks menu (choose only one), comes with Nespresso coffee, a selection of teas and orange juice

Your selection of working style lunch served with freshly brewed coffee and teas

Iced water, notepads, pens and sweet selection

Standard audio visual equipment including screen, non-electronic whiteboard/flipchart with markers

Complimentary parking for the group organiser (1 parking space)



* Minimum spend per conference room applies, otherwise a room hire applies.



conference

welcome | services & facilities | **day packages** | breaks | breakfast | lunch & dinner | cocktail | beverages | gallery

breakfast meeting packages

working continental breakfast package

\$30 per person

Complimentary morning event suite hire

Continental breakfast (see [menu](#))

Iced water, notepads, pens
and sweet selection



hot plated breakfast package

\$40 per person

Complimentary morning event suite hire

Hot plated breakfast (see [menu](#))

Iced water, notepads, pens
and sweet selection

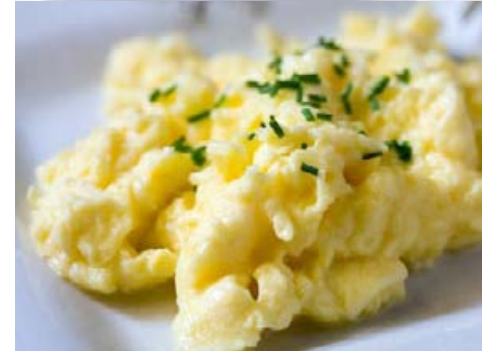



conference

welcome | services & facilities | **day packages** | breaks | breakfast | lunch & dinner | cocktail | beverages | gallery

Prices are subject to change without notice. Prices displayed are GST-inclusive.

room hire

Cornwall suite

\$150 per full day (8.00am – 5.00pm)

\$100 per half day (8.00am – 12.00pm or 1.00pm – 5.00pm)

Boardroom

\$120 per full day (8.00am – 5.00pm)

\$90 per half day (8.00am – 12.00pm or 1.00pm – 5.00pm)

Two bedroom suite

\$150 per full day (8.00am – 5.00pm)

\$100 per half day (8.00am – 12.00pm or 1.00pm – 5.00pm)

Penthouse (subject to availability)

\$180 per full day (8.00am – 5.00pm)

\$150 per half day (8.00am – 12.00pm or 1.00pm – 5.00pm)





conference

welcome | services & facilities | **day packages** | breaks | breakfast | lunch & dinner | cocktail | beverages | gallery

additions

internet access

Our conference areas and restaurant offer wireless internet (must provide own laptop)

Single computer **\$6 per hour**

All day access for up to 10 computers **\$100**

additional audio visual equipment

We would be happy to provide a quotation for you from local suppliers on additional or non standard audio visual equipment.

delegate massage rewards packages

Reward your delegates with a 10 minute neck and shoulder massage.

60 minute package (6 delegates) **\$95**

120 minute package (12 delegates) **\$160**



THE SEBEL



LAUNCESTON

Cnr St John & William Streets Launceston TAS 7250

P +61 3 6333 7555 - F +61 3 6333 7559

E events@tsl.mirvac.com

W www.mirvac-hotels.com

conference

welcome | services & facilities | day packages | **breaks** | breakfast | lunch & dinner | cocktail | beverages | gallery



breaks

on arrival

morning & afternoon
tea breaks





conference

welcome | services & facilities | day packages | **breaks** | breakfast | lunch & dinner | cocktail | beverages | gallery

Prices are subject to change without notice. Prices displayed are GST-inclusive.

arrival tea and coffee

\$6 per person

Nespresso coffee and
a selection of teas

morning or afternoon tea breaks

\$10 per person

Served with Nespresso coffee and
selection of teas and one of the following:

Selection of pastries and croissants

Freshly baked cookies or shortbread

Warm scones, house jams,
King Island cream

Assorted house-baked muffins

Chocolate brownies

Individual vegetarian quiche

Mini egg, bacon and cheese pies



THE SEBEL



LAUNCESTON

Cnr St John & William Streets Launceston TAS 7250

P +61 3 6333 7555 – F +61 3 6333 7559

E events@tsl.mirvac.com

W www.mirvac-hotels.com

conference

welcome | services & facilities | day packages | breaks | **breakfast** | lunch & dinner | cocktail | beverages | gallery

breakfast

working continental
buffet breakfast

hot plated breakfast





conference

welcome | services & facilities | day packages | breaks | **breakfast** | lunch & dinner | cocktail | beverages | gallery

Prices are subject to change without notice. Prices displayed are GST-inclusive.

working continental buffet breakfast

\$30 per person

Nespresso coffee and a selection of teas and juices

Continental cereal and muesli station

Bakery baskets with chef's selection of fresh pastries

Bread and preserves; including white,
wholemeal, rye, grain, for toasting

Fresh cut seasonal fruit plate

Yoghurt and mixed berries





conference

welcome | services & facilities | day packages | breaks | **breakfast** | lunch & dinner | cocktail | beverages | gallery

Prices are subject to change without notice. Prices displayed are GST-inclusive.



hot plated breakfast

\$40 per person

Nespresso coffee and a selection of teas and juices

Poached eggs, sourdough toast, bacon, sausage, tomato

Continental cereal and muesli station

Bakery baskets with chef's selection of fresh pastries

Bread and preserves; including white, wholemeal, rye, grain, for toasting

Fresh cut seasonal fruit plate

Yoghurt and mixed berries



THE SEBEL



LAUNCESTON

Cnr St John & William Streets Launceston TAS 7250

P +61 3 6333 7555 - F +61 3 6333 7559

E events@tsl.mirvac.com

W www.mirvacotels.com

conference

welcome | services & facilities | day packages | breaks | breakfast | **lunch & dinner** | cocktail | beverages | gallery

lunch & dinner

working lunch packages

set menu





conference

welcome | services & facilities | day packages | breaks | breakfast | **lunch & dinner** | cocktail | beverages | gallery

light working lunch

\$30 per person

Light working lunch served in meeting breakout room or Market Square restaurant with fruit juices, coffee and tea

Selection of breads and baguettes with assorted fillings, including:

Ham, cheese, tomato, relish

Chicken, lettuce, mayonnaise

Egg, chive mayonnaise

Mixed leaf salad

Fresh cut seasonal fruit plate





conference

welcome | services & facilities | day packages | breaks | breakfast | **lunch & dinner** | cocktail | beverages | gallery

gourmet working lunch

\$35 per person

Gourmet working lunch served in meeting breakout room or Market Square restaurant with fruit juices, coffee and tea

Selection of breads and baguettes with assorted fillings, including:

Smoked salmon, cucumber, horseradish cream

Roast beef, tomato kasundi

Oven roasted vegetables, pesto

Assorted share pizzas

Large vegetarian quiches

Chef's selection of gourmet salads

Fresh cut seasonal fruit and Tasmanian cheese plate





conference

welcome | services & facilities | day packages | breaks | breakfast | **lunch & dinner** | cocktail | beverages | gallery

packed lunch

\$20 per person

Meeting over? Want to ensure your delegates have a lunch on their way back to the office. The packed lunch is the way to go.

Ham and salad sandwich or
caesar salad

Baked muffin

Piece of fruit

Chocolate bar

Fruit juice

600ml spring water





conference

welcome | services & facilities | day packages | breaks | breakfast | **lunch & dinner** | cocktail | beverages | gallery

bbq buffet lunch

\$40 per person

BBQ buffet lunch served on the Market Square terrace
with fruit juices, soft drinks, coffee and tea

Bakery basket of assorted breads, bread rolls

Selection of gourmet meats cooked
on the terrace BBQ, including:

Black Forest Italian sausages

Skewered prawns, chilli, garlic

Lamb cutlets, rosemary, balsamic, olive oil

Chef's selection of gourmet salads

Variety of condiments, mustards, sauces, relish

Individual pavlovas with assorted fillings

Fresh cut seasonal fruit and Tasmanian cheese plate





conference

welcome | services & facilities | day packages | breaks | breakfast | **lunch & dinner** | cocktail | beverages | gallery

set dinner menu

Two course, alternate menu **\$55 per person**

Three course, alternate menu **\$65 per person**

Your set menu dinner package includes:

Complimentary use of Market Square restaurant or Event Suite*

Personalised menus

Your choice of two dishes per course
served alternately to your guests

Chef's selection of side dishes to accompany main

Freshly brewed coffee and a selection of teas

[entrée](#) | [main](#) | [dessert](#)

Minimum 6 people (A la carte menu option available for smaller groups).

Prices are subject to change without notice. Prices displayed are GST-inclusive.



*Events-Suite footnote here?>





conference

welcome | services & facilities | day packages | breaks | breakfast | **lunch & dinner** | cocktail | beverages | gallery

entrée

Salt and pepper squid,
pickled cucumber, chilli jam

Goat's cheese, tomato and onion tartlet,
rocket pine nut salad

Smoked salmon, avocado panna cotta,
mango almond salsa

Market Square caesar,
poached egg, anchovy aioli

Smoked chicken, butter lettuce,
capsicum, olive, basil dressing





conference

welcome | services & facilities | day packages | breaks | breakfast | **lunch & dinner** | cocktail | beverages | gallery



main

Salmon fillet, charred asparagus, prawn
rice noodle salad

Twice cooked gruyere soufflé, corn fritter,
avocado salsa

Cumin lamb, warm bean and potato
salad, walnut vinaigrette

Eye fillet char grilled, mushroom pave,
onion jam, truffle oil glaze

Dukkah chicken breast, chestnut spatzle,
glazed carrots, sage butter





conference

welcome | services & facilities | day packages | breaks | breakfast | **lunch & dinner** | cocktail | beverages | gallery

Prices are subject to change without notice. Prices displayed are GST-inclusive.

dessert

Summer berry pudding, double cream,
spiced vanilla syrup

Roasted peach and frangipane tart,
cinnamon ice cream

Honey semifreddo, roasted fruits,
hazelnut praline

Chocolate mocha tart, rocky road
ice-cream, kahlua cream



THE SEBEL



LAUNCESTON

Cnr St John & William Streets Launceston TAS 7250

P +61 3 6333 7555 - F +61 3 6333 7559

E events@tsl.mirvac.com

W www.mirvacotels.com

conference

welcome | services & facilities | day packages | breaks | breakfast | lunch & dinner | **cocktail** | beverages | gallery

cocktail

post function cocktail
packages

cocktail canapés





conference

welcome | services & facilities | day packages | breaks | breakfast | lunch & dinner | **cocktail** | beverages | gallery

post function cocktail packages

Complete your meeting with a well
deserved drink with your delegates.

30 minute

\$15 per person

60 minute

\$25 per person

NV Hardy's Brut Reserve Sparkling

Hardy's Chardonnay

Hardy's Shiraz Cabernet

James Boag's Premium Light, James

Boag's Draught

Soft drinks and fruit juice





conference

welcome | services & facilities | day packages | breaks | breakfast | lunch & dinner | **cocktail** | beverages | gallery

Prices are subject to change without notice. Prices displayed are GST-inclusive.

cocktail canapés

All items are served on trays, and will be offered to guests, then placed on a central table for self-service.

selection of 3 canapés

Suitable for 2 hour duration
(6 pieces per person)

\$29 per person

selection of 6 canapés

Suitable for 3 hour duration
(12 pieces per person)

\$37 per person

selection of 9 canapés

Suitable for 4 hour duration
(18 pieces per person)

\$50 per person

Please select your choice of canapés
from the following pages.

[cold canapés](#) | [hot canapés](#)
[dessert](#)





conference

welcome | services & facilities | day packages | breaks | breakfast | lunch & dinner | **cocktail** | beverages | gallery

cold

Open gourmet sandwiches

Open gourmet vegetarian sandwiches*

Atlantic smoked salmon and
Camembert savory boats

Waldorf Salad Tartlets*

Vietnamese rice paper roll
(vegetarian option available)

Warm bruschetta*

Tandoori chicken bites

Profiteroles, herbed goat's cheese filling*



* (V) vegetarian





conference

welcome | services & facilities | day packages | breaks | breakfast | lunch & dinner | **cocktail** | beverages | gallery



hot

Chinese chilli meatballs

Tuna mornay open tartlets

Marinated lamb cutlets with a
Tzatziki dip

Salt and pepper squid

Goats cheese tartlet*

Gourmet Focaccia bites*

Crumbed and marinated mushrooms*

Caramelized onion and
blue cheese calzone*

Mini quiche lorraine

* (V) vegetarian





conference

welcome | services & facilities | day packages | breaks | breakfast | lunch & dinner | **cocktail** | beverages | gallery

Prices are subject to change without notice. Prices displayed are GST-inclusive.

dessert

- Tiramisu
- Chocolate mocha tart
- Chocolate mousse
- Berry tartlet





conference

welcome | services & facilities | day packages | breaks | breakfast | lunch & dinner | cocktail | **beverages** | gallery

beverages

sparkling and champagne

white wine list

red wine list

dessert wine

standard package

premium package





conference

welcome | services & facilities | day packages | breaks | breakfast | lunch & dinner | cocktail | **beverages** | gallery

Prices are subject to change without notice. Prices displayed are GST-inclusive.

sparkling and champagne

Price per bottle

Jansz Tasmania **\$62**
Pipers River, Tasmania

Ninth Island **\$57**
Pipers River, Tasmania

Emeri Sparkling Sauvignon Blanc **\$36**
South East Australia



Our hotel practices responsible service of alcohol.





conference

welcome | services & facilities | day packages | breaks | breakfast | lunch & dinner | cocktail | **beverages** | gallery

Prices are subject to change without notice. Prices displayed are GST-inclusive.

white wine list

Price per bottle

Wellington Riesling \$58 Cambridge, Tasmania	Ninth Island Sauvignon Blanc \$53 Pipers River, Tasmania
Goaty Hill Riesling \$56 Tamar Valley, Tasmania	Pipers Brook Estate Chardonnay \$79 Pipers River, Tasmania
Ninth Island Pinot Grigio \$50 Pipers River, Tasmania	Vintner's Nest Chardonnay \$53 Rowella, Tasmania
Notley Gorge Pinot Grigio \$49 Tamar Valley, Tasmania	De Bortoli Gulf Station Chardonnay \$47 Yarra Valley, Victoria
Bream Creek Sauvignon Blanc \$61 Cambridge, Tasmania	Hardy's Collection Chardonnay \$36 Reynella, South Australia



Our hotel practices responsible service of alcohol.





conference

welcome | services & facilities | day packages | breaks | breakfast | lunch & dinner | cocktail | **beverages** | gallery

Prices are subject to change without notice. Prices displayed are GST-inclusive.

red wine list

Price per bottle

Bass Fine Wines Bass Strait Pinot Noir \$58 Rosevears, Tasmania	Vintner's Nest Cabernet Sauvignon \$55 Rowella, Tasmania
Notley Gorge Pinot Noir \$49 Tamar Valley, Tasmania	Hollick Shiraz Cabernet Sauvignon \$47 Coonawarra, South Australia
RockBare Grenache Shiraz Mourvedre \$55 McLaren Vale, South Australia	Hardy's Collection Shiraz Cabernet Sauvignon \$36 Reynella, South Australia
Plunkett Strathbogrie Ranges Merlot \$56 Strathbogrie Ranges, Victoria	Mojo Shiraz \$44 Barossa Valley, South Australia
Holm Oak Cabernet Merlot \$53 West Tamar, Tasmania	Mr Riggs 'The Gaffer' Shiraz \$52 McLaren Vale, South Australia



Our hotel practices responsible service of alcohol.





conference

welcome | services & facilities | day packages | breaks | breakfast | lunch & dinner | cocktail | **beverages** | gallery

Prices are subject to change without notice. Prices displayed are GST-inclusive.

dessert wine

Price per bottle

Frogmore Creek Iced Reisling **\$55**
Cambridge, Tasmania



Our hotel practices responsible service of alcohol.





conference

welcome | services & facilities | day packages | breaks | breakfast | lunch & dinner | cocktail | **beverages** | gallery

Prices are subject to change without notice. Prices displayed are GST-inclusive.

standard package

2 hours **\$35**

3 hours **\$43**

4 hours **\$50**

5 hours **\$57**

James Boag's Premium Light
James Boag's Draught

NV Hardy's Brut Reserve Sparkling

2007 Hardy's Chardonnay
2007 Hardy's Shiraz Cabernet

Soft drinks and fruit juice

Beverage packages charged on
consumption available upon request.

premium package

2 hours **\$50**

3 hours **\$58**

4 hours **\$68**

5 hours **\$72**

James Boag's Premium Light
James Boag's Premium

Ninth Island Sparkling

Notley Gorge Pinot Grigio
Notley Gorge Pinot Noir

Soft drinks, fruit juice and mineral water



Our hotel practices responsible service of alcohol.



THE SEBEL



LAUNCESTON

Cnr St John & William Streets Launceston TAS 7250

P +61 3 6333 7555 – F +61 3 6333 7559

E events@tsl.mirvac.com

W www.mirvac-hotels.com

conference

welcome | services & facilities | day packages | breaks | breakfast | lunch & dinner | cocktail | beverages | **gallery**

gallery

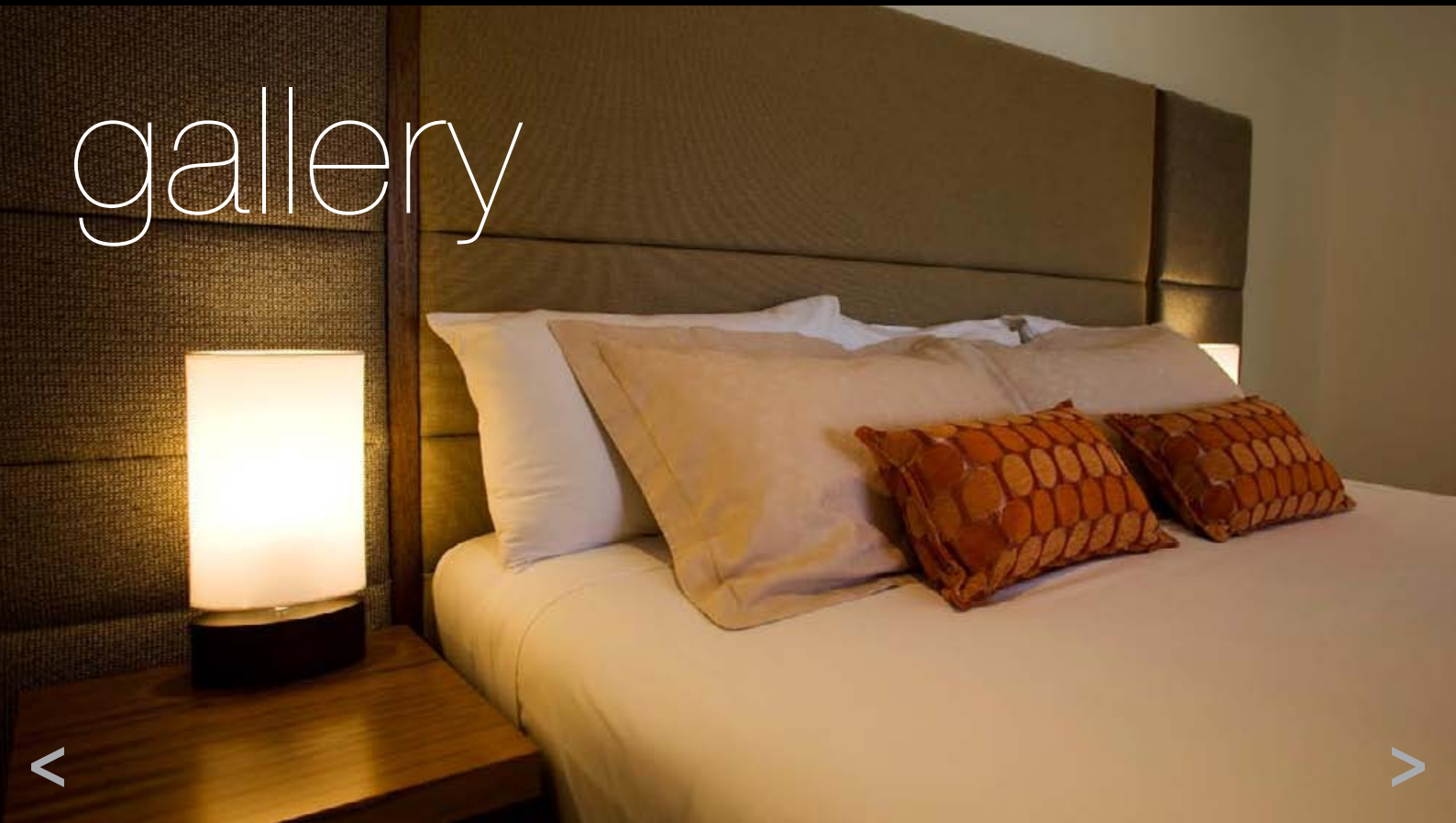



conference

welcome | services & facilities | day packages | breaks | breakfast | lunch & dinner | cocktail | beverages | **gallery**



Hotel entrance



Terrace dining



24 hour Reception



Restaurant lobby



Hotel lobby



Indoor & terrace dining





conference

welcome | services & facilities | day packages | breaks | breakfast | lunch & dinner | cocktail | beverages | **gallery**



Event dining



Restaurant entrance



One bedroom deluxe suite



King bedding



Two bedroom spa suite



One bedroom spa suite





conference

welcome | services & facilities | day packages | breaks | breakfast | lunch & dinner | cocktail | beverages | **gallery**



Private dining



Cornwall suite



Cornwall suite – theatre style



Boardroom



Terrace event



Complimentary stationery

