



# RYDGES

HOBART

## Meeting Facilities

Conferences • Events • Functions

### Local Attractions

#### HOBART – THE HIDDEN WONDERLAND

Discover the precious jewel in Australia's south and experience some of the wonderful historic charm, cultural diversity and diverse attractions on offer.

- Hobart Summer Festival
- Experience Salamanca Place or the Markets on a Saturday
- Drive through the Huon Valley
- Visit Constitution Dock
- Climb Mount Wellington
- Floral Shows
- Hobart Waterfront
- Battery Point
- Glenorchy and the northern suburbs
- Clarence and the Eastern Shore

- Sailing
- Scuba Diving
- Orienteering
- Windsurfing
- Wine Tours
- Team building & adventure exercises
- Kayaking

#### DAY TRIPS IN AND AROUND HOBART

##### Cadbury Chocolate Factory Tour & River Cruise

Take a cruise on the scenic Derwent River to the Cadbury Chocolate Factory, established since 1921. Taste chocolate samples as you follow the guided tour of the famous chocolate making factory.

##### Richmond Wine Route Chauffeured Tour

Forget the driving! Be chauffeured around the southern Tasmanian wine route. Sample fine Tasmanian wines and enjoy the scenery of historic Richmond, the home of the oldest preserved colonial convict gaol, bridge and Catholic church.

##### Tahune Airwalk (Forest Canopy Airwalk)

Experience the adventure and journey up to 45 metres above the forest floor. View Tasmania's famous Huon pine and enjoy magnificent rainforest.

#### Par Avion Wilderness Flights

Enjoy scenic wilderness flights across Tasmania's world heritage listed South-West.

#### Antarctic Adventure (Theme venue)

Antarctic Adventure brings the world's largest and loneliest continent to life through dozens of exciting, interactive and informative displays and activities.

#### Port Arthur Historic Site Ghost Tours

Join a lantern lit tour of Port Arthur at night. Hear spine-chilling stories of apparitions and strange occurrences from the convict era to the present day.

#### HOW TO GET THERE

Rydges Hobart is approximately 25 minutes drive from the Hobart Airport. Major airlines and some smaller airlines fly to Hobart, mostly from capital cities. If driving, you can bring your own car on the ferry, which travels between Melbourne and Devonport, in Tasmania's north.

#### SURROUNDING COUNTRYSIDE AND ACTIVITIES

Add energy to your conference programme by taking part in a wide cross section of adventure.

Water shapes and surrounds Hobart City, however there are plenty of things to do on and off the water....

- Bush Walking
- Go-Karting
- Horse Riding
- Hot Air Ballooning

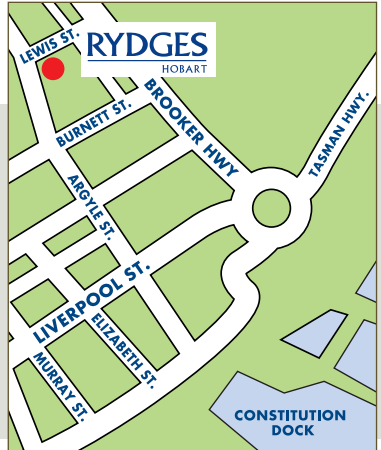

## RYDGES

HOBART

Cnr. of Argyle & Lewis Streets,  
Hobart Tasmania 7002  
Ph: 61 3 6231 1588 Fax: 61 3 6231 1916  
Toll Free: 1800 801 703  
Email: functions\_hobart@rydges.com  
Internet: www.rydges.com/hobart





## Conference Room Configurations

## Conference Features

Rydges Hobart is only minutes from the business centre of Hobart, and combines historic elegance with modern style.

Offering three superb conference options that can accommodate up to 150 patrons, Rydges Hobart can cater to your every demand. The Federation Room for up to 90 people is colonial in design with antique furnishings and an abundance of natural light.

The Edwardian Room for up to 150 people is a quiet and secluded facility. It is contemporary in design offering bright and airy features with large windows which surround the perimeter of the room.

Located on the first floor of the hotel, The Wellington Room appeals to those guests that want a little more intimate atmosphere. This more modern room offers seclusion from the other function venues and is suitable for up to 25 guests.

The Boardroom and some of the more spacious suites are perfect for smaller meeting areas or breakout plenary sessions. Rydges Hobart is the natural choice for residential conferences, with an abundance of leisure activities for accompanying families and partners within the hotel and around Hobart.

Out-catering in unique locations around Hobart is also available through Rydges Catering, a division of Rydges Hobart. Take a day out of the conference room, and select an area that will make your conference one to remember.

Theme dinners, corporate lunches or formal occasions - your imagination is the only thing that will restrict your next conference at Rydges Hobart.

### CONFERENCE ROOM FEATURES

- All have natural light, individual light control and high ceilings
- Personal conference concierge service
- Complimentary Business Centre including: PC, Fax, Printer, Copier, Internet Access, Modem Point and full secretarial services
- Professional audio visual technicians available if required
- Telephone lines in all rooms that can be used for internet access.

### GUEST ROOMS

Rydges Hobart has 63 luxury suites including:

- 44 standard suites
- 19 Antiques suites including the Presidential Suite and two suites which are located in the heritage listed Trust Cottage.
- All accommodation includes kitchen and dining facilities.

### ROOM FACILITIES

All suites at Rydges Hobart feature the following guest amenities:

- Mini Bar
- Kitchen facilities
- Complimentary in-house movies
- STD/ISD direct dial telephones
- Tea & coffee making facilities
- Iron & ironing board

### DINING CONCEPTS

#### Brickfields Restaurant & Bar

Brickfields Restaurant offers guests a wide selection of traditional Australian cuisine. Local produce is a feature and the décor in the restaurant reflects the historic ambience of the hotel. Open seven days serving breakfast, lunch and dinner.

### HOTEL FACILITIES

- Business centre
- Heated swimming pool
- Spa and sauna
- Complimentary access to Fitness Domain & Aquatic Centre
- 24 hour reception
- 24 hour room service
- Guest laundry and valet service
- Car parking

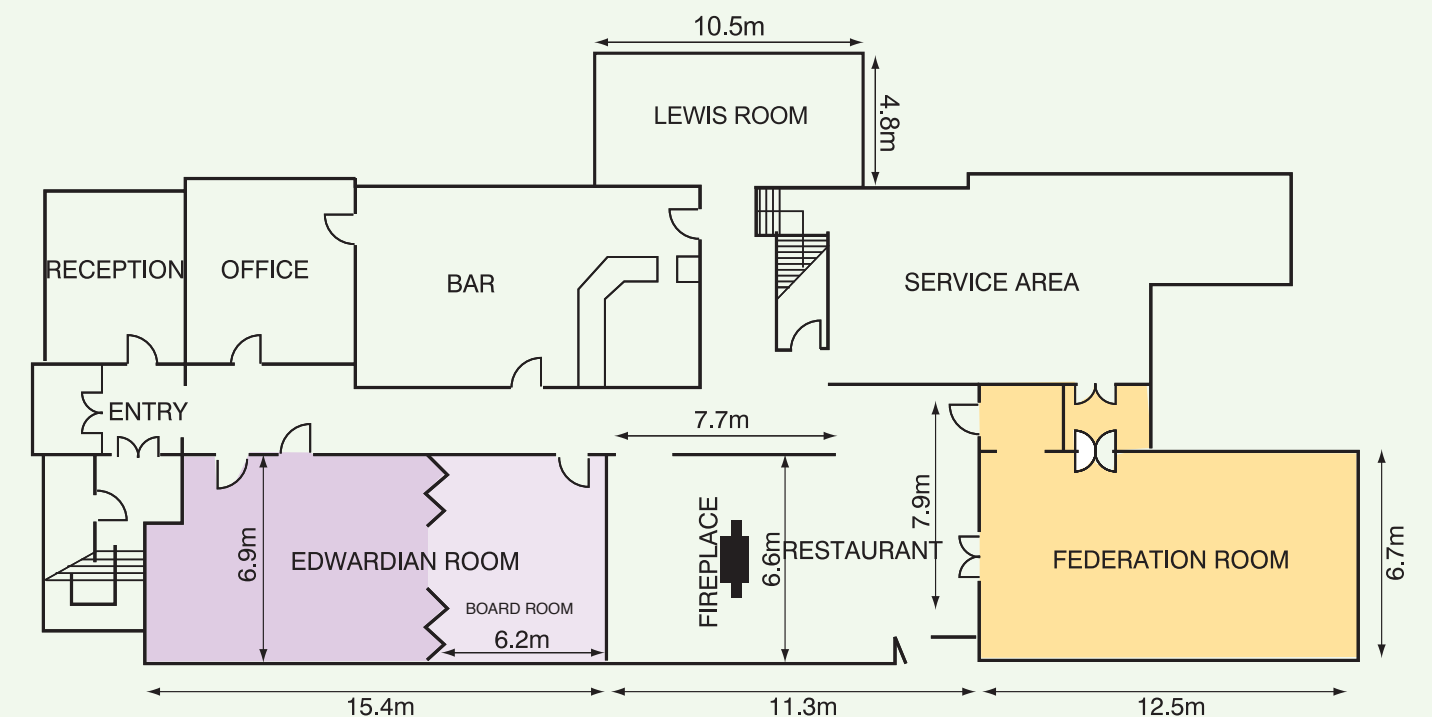

ROOM	AREA (SQ/M)	CEILING	THEATRE	BOARD	DINING	COCKTAIL	U-SHAPE
Federation Room	83.75	4m	90	35	80	120	30
Edwardian Room	106.26	4m	120	45	110	150	40
Wellington Room	27	4m	20	20	20	40	15
Board Room	42.78	4m	35	20	25	40	15
Lewis Room	50.4	3m	60	35	50	70	30



GROUPS UP TO 150