

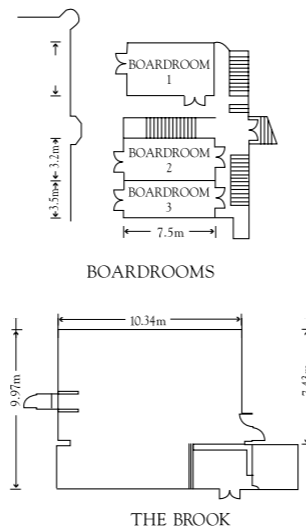

MEETING ROOMS & CAPACITIES

Key □ Pillars — Windows

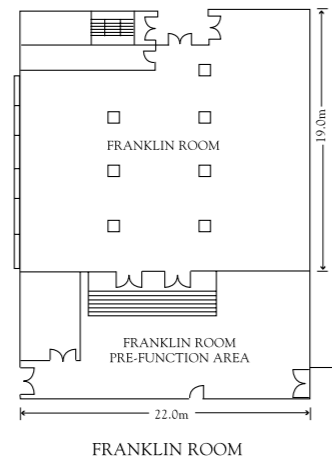
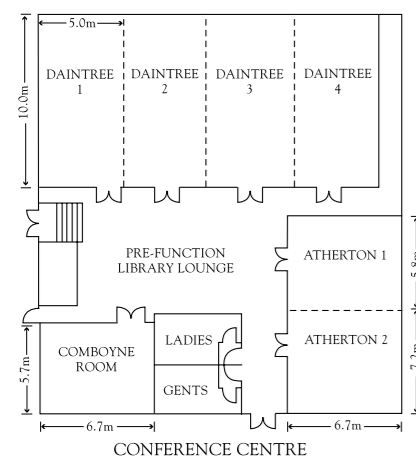

LOCATION

Located in the heart of Sydney's commercial and technology district, this hotel is only a few minutes from Olympic Park and Homebush Bay and 15 minutes from the Harbour Bridge and CBD. A truly relaxing tropical oasis with indoor/outdoor swimming pool, Rebound Ace tennis courts and state-of-the-art health club, making it the perfect award winning venue for conferences with numerous social activities.

MEETING ROOM FEATURES & TECHNICAL INFORMATION

- 12 rooms catering from four to 240 people
- Open fireplace in pre-function Library area
- Elegant wood panelled walls
- Two venues with natural light
- Pillarless ballroom of 200m²
- Audio visual company on-site
- Individually controlled air conditioning and light dimmers in all rooms
- PABX line in all rooms
- Service lift 2.2m (H) x 1m (W) x 1.25 (D)
- Ten exhibitor booth capacity in Convention Centre pre-function area
- Outdoor lagoon and terrace areas
- Access to outdoor terrace from The Brook
- Complimentary car parking for delegates

HOTEL FEATURES

- Only all-suite resort-style hotel in Sydney
- Fully refurbished guest suites
- Guest suites feature a 'home office' concept in the arrival room and a 'total relaxation' concept in the bedroom
- High-speed Internet access in all guest suites
- Courtesy shuttle bus to surrounding business parks
- Tropical gardens
- Extensive health and fitness facilities
- Indoor/outdoor swimming pool, spa and tennis court

ACCOMMODATION

(256 rooms in total)

- Superior Suite 115
- Deluxe Suite 102
- Executive Suite 29
- One Bedroom Apartment 8
- Sir Stamford Suite 2

DINING AND BAR

- Parrot's Brasserie
- Parrot's Bar

CONTACT

Cnr Epping & Herring Roads
 North Ryde, NSW 2113 Australia
 Telephone +61 2 9888 1077
 Facsimile +61 2 9805 0655
 Email sales@snr.stamford.com.au
 www.stamford.com.au

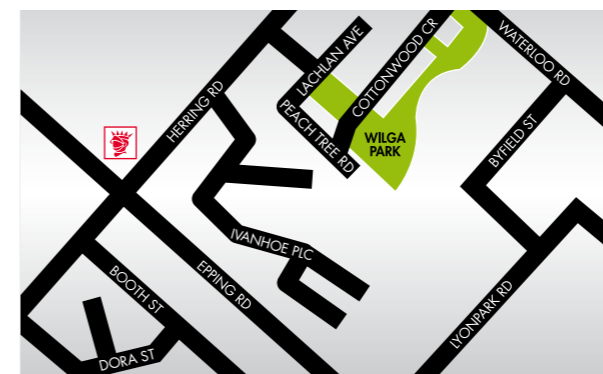

STAMFORD MEETING ROOMS AND CAPACITIES									
Conference Rooms	Height (m)	Area (m ²)	Theatre	Classroom	Banquet	U Shape	Cocktails	Boardroom	Cabaret
Daintree 1*	4.4	50	30	20	30	15	40	20	15
Daintree 1/2*	4.4	100	90	50	60	30	90	30	30
Daintree 1/2/3*	4.4	150	140	75	80	40	140	40	60
Daintree Ballroom*	4.4	200	240	120	180	40	240	60	100
Atherton 1*	3.8	39	30	15	30	14	40	10	15
Atherton 2*	3.8	48	30	20	30	14	50	10	15
Atherton total*	3.8	86	80	35	70	30	80	30	40
Comboyne Room*	3.1	38	30	12	30	12	20	14	15
Boardroom 1	2.3	33	25	12	12	8	25	12	8
Boardroom 2	2.3	26	20	10	10	-	20	10	8
Boardroom 3	2.3	22	20	10	10	-	20	10	8
Franklin Room	2.4	418	200	100	200	30	200	20	120
Franklin Room (Pre-Function)	2.4	91	-	-	-	-	50	-	-
The Brook*	2.6	96	60	40	70	25	60	24	30

*Wheelchair accessible.