



Located on the fringe of the CBD, theatres, fashionable restaurants and Melbourne's famous shopping precinct, Mantra on the Park offers spectacular views of the beautiful Carlton Gardens and city skyline.

Conference Facilities

Situated on the fringe of the CBD, Mantra on the Park is only minutes from some of the best shopping, restaurants and theatres this cosmopolitan city has to offer.

With 144 one and two bedroom apartments, the hotel offers two penthouse apartments, indoor salt heated pool and sauna. Private balconies offer fantastic views of the Melbourne city skyline and the beautiful Carlton Gardens.

Hotel Details

Reception Hours: 24 hours
AAA Star Rating: 4 star

Accommodation

- 144 one and two bedroom apartments

Guest services and facilities

- 24 hour foreign exchange desk
- concierge
- undercover parking (fees apply)
- express check-out
- indoor heated salt pool and sauna
- gym available off site
- same day laundry service
- major credit cards accepted

Meeting Room Facilities

- 1x Boardroom seating up to 16 delegates
- 2x Penthouse apartments are available for up to 26 delegates with natural lighting
- The Penthouse size is 35sqm - the ceiling height is 2.54m
- Business support services/secretarial services (upon request)
- Food and beverage catering
- Equipment hire

Packages

Ideally suited for small meetings and presentations, our dedicated and experience Conference Executive can tailor a package to suit your requirements.

Floor Plans

The floor plans are indicative only.

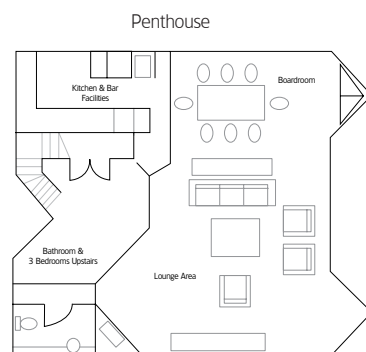

The Boardroom

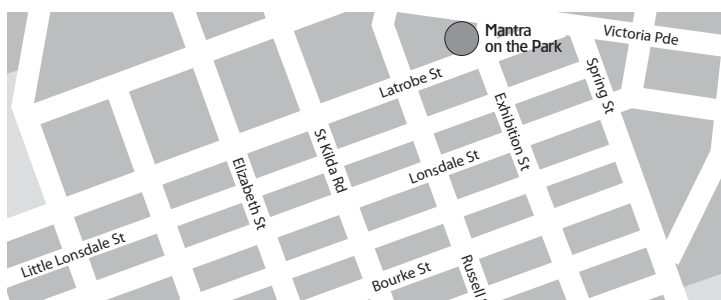
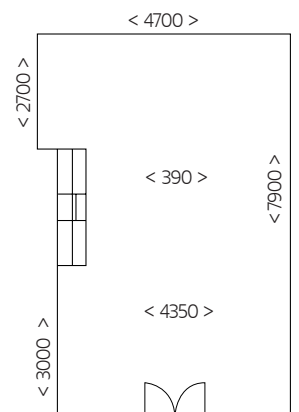

Mantra on the Park

333 Exhibition Street
Melbourne VIC 3000
t +61 3 9668 2500
f +61 3 9668 2599
e park.func@mantra.com.au

Bookings and Enquiries

e conference@stellagroup.com.au
w www.mantra.com.au

