

(Explore...



(space to focus ...

... means Hemisphere is flexible and professional. Providing headspace, physical space, freedom, brightness and openness, Hemisphere frees you from the constraints of your environment. Hemisphere helps you think, relate and **learn with an open mind.**

Designed with business in mind, Hemisphere Conference Centre & Hotel offers a unique range of professional services and over **twenty flexible spaces** in a combination that best suits you, from intimate meetings to large events of up to **400 guests.**

Hemisphere's professional team of conference management, hotel and culinary staff work to ensure that you **achieve your intended outcome.**



(meeting of minds ...

Hemisphere is **interested in the outcomes** its clients are seeking from their conference, training, meeting or event.

Hemisphere's facilities and services all work toward helping you **achieve your business goals.**

Maximising natural light, Hemisphere's unique range of conference, training, seminar and boardroom spaces and Latitude Theatre offer all you need for professional presentations.

(connect ...

Whether you are organising simple networking drinks in **Swirl Bar**, a conference, banquet or gala dinner; product launch or celebration, Hemisphere has the flexible approach to make it **successful.**

Enjoy innovative Australian cuisine at **Infuse Restaurant.**

Hemisphere's culinary team can tailor a menu for your event: for breakfast, lunch and dinner.

Connect with one of Hemisphere's conference professionals to design a **complete residential package**, inclusive of drinks in Swirl Bar, followed by dinner in Infuse Restaurant.



(relax ...

... **recharge** and **refresh** at Hemisphere Hotel. Experience Hemisphere's professional service and modern spacious four-star accommodation suites. Deluxe and Executive suites feature a **corner spa** for **relaxing** at the end of the day. Complimentary in-house movies; room service; twenty-four hour reception; gym; free onsite car parking and a complete range of business services help to make your stay effortless.

Hemisphere Hotel is conveniently located in Melbourne's South-East, close to **Brighton beach**; Australia's finest public and private **golf courses** and major **shopping attractions**.





(In brief...

Hemisphere Conference Centre is the perfect place for conferences, meetings and training. Escape from the gridlock of your office - so you can concentrate on your business goals.

Conferences

- > 20 conference spaces, flexible room layouts
- > Spacious foyers
- > Complimentary car parking

Hemisphere HOTEL and Functions

- > 50 four-star accommodation suites
- > *Swirl* Bar, fully licensed
- > *Infuse* Restaurant, modern Australian cuisine, open for breakfast, lunch and dinner
- > Spacious pre-function areas

Location

- > 25 minutes from CBD
- > 50 minutes from Melbourne Airport
- > Melway's Ref: 77, G5





(Relax...

...recharge and refresh at Hemisphere Hotel. Experience our professional service and modern, spacious four-star accommodation suites.

- > Queen sized beds
- > Corner spas
- > Complimentary inhouse movies
- > Free on-site car parking
- > 24 hour reception
- > Mini bar
- > Room service
- > Hair dryers
- > Broadband Internet Access

Located close to bayside beaches, Australia's finest golf courses and major shopping centres.

Contact Hemisphere Hotel reservations for current room rates.

Telephone: +61 3 9093 7999

(HEMISPHERE HOTEL



(Capacity and dimensions

Capacity by Style

Dimensions

	Theatre Style	Class Room	Boardroom	Hollow Square	U-shape	Round / Workshop Tables	Length metres	Width metres	Area (approx) metres	Ceiling Height metres
Level One										
Centera	350	96	N/A	N/A	40	16	15.6	17.4	271	3.6
Exhibition Space	N/A	N/A	N/A	N/A	N/A	N/A	40	7	280	9.5
Radius 2	84	38	18	36	24	5	10	9.5	96	2.7
Radius 3	34	12	12	16	10	1	6.6	5	33	2.7
Radius 4	90	30	22	32	24	5	12	8	96	2.7
Level Two										
Axis Boardroom	N/A	N/A	10	N/A	N/A	N/A	6.6	6	36	2.7
Axis 1	15	N/A	6	N/A	N/A	1	3.6	6	22	2.7
Axis 2	20	8	10	N/A	N/A	1	4	6	24	2.7
Axis 3	80	32	18	30	24	5	8	10	80	2.7
Latitude 1	64	28	18	28	22	4	7	12	84	2.7
Latitude 2	72	32	18	30	24	5	8	12	96	2.7
Latitude 3	80	28	18	30	20	5	8	12	96	2.7
Latitude 1 & 2	174	68	26	48	38	9	15	12	180	2.7
Latitude 2 & 3	190	70	30	52	38	9	16	12	192	2.7
Latitude 1, 2 & 3	250	98	N/A	68	40	14	23	12	276	2.7
Latitude Theatre	94	N/A	N/A	N/A	N/A	N/A	12	6	72	4.5
Level Three										
Focus 1	26	10	10	N/A	N/A	1	5.8	5.8	33	2.7
Focus 2	26	10	10	16	12	1	6.1	5.8	35	2.7
Focus 3	24	8	10	N/A	N/A	1	6.8	5.2	35	2.7
Outlook 1	30	10	10	16	12	2	7.2	6.5	47	2.7
Outlook 2	38	14	10	16	12	2	7.2	6.2	45	2.7
Outlook 1 & 2	66	36	22	28	22	6	7.2	12.7	92	2.7
Outlook 3	30	16	14	20	14	2	6.5	6.8	44	2.7
Outlook 4	30	14	14	20	12	2	6.2	6.8	42	2.7
Outlook 3 & 4	80	34	22	32	26	6	12.7	6.8	86	2.7



(Spaces...

Level One

- > Welcome - Reception
- > Exhibition Space
- > Centera
- > Radius 2, 3 and 4
- > Swirl Bar
- > Infuse Restaurant
- > Restrooms
- > Disabled restroom

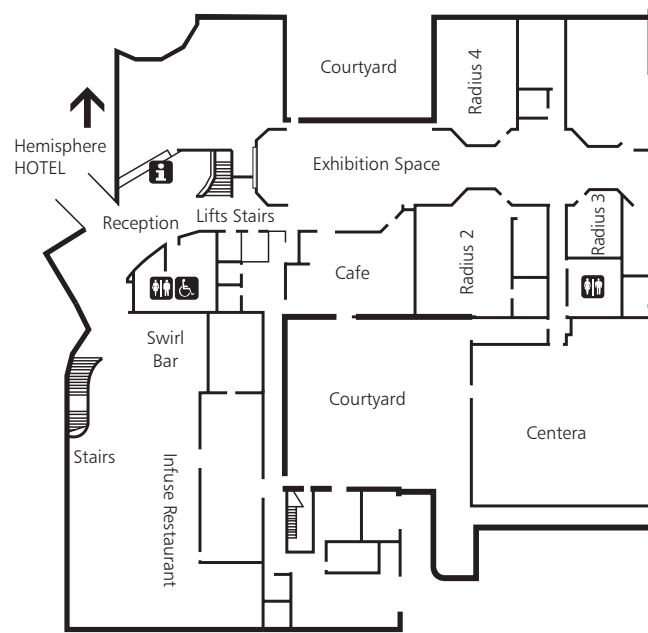

Level One

Level Two

- > Latitude Theatre
- > Latitude 1, 2 and 3
- > Axis Lounge
- > Axis Boardroom
- > Axis 1, 2 and 3
- > Restrooms
- > Public telephone

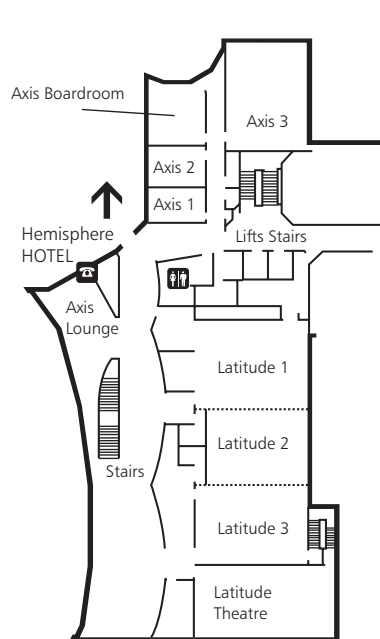

Level Two

Level Three

- > Focal Point, Business Centre
- > Focus 1, 2 and 3
- > Outlook 1, 2, 3 and 4
- > Restrooms
- > Public telephone

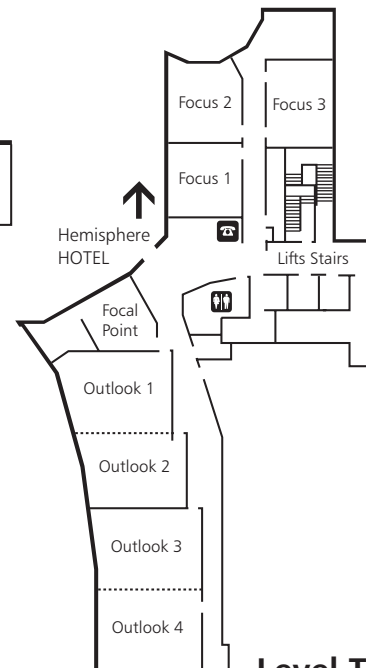

Level Three



HEMISPHERE

CONFERENCES/TRAINING/MEETINGS/HOTEL

Hemisphere Conference Centre and Hotel
488 South Road, Moorabbin Victoria 3189
PO Box 42, Holmesglen Victoria 3148 Australia
Telephone: +61 3 9093 7999 Facsimile: +61 3 9209 5907
Email: info@hemisphere.com.au Web: www.hemisphere.com.au