



LOCAL ATTRACTIONS

Melbourne is a city famous for its cultural, shopping and sporting activities. From Rydges North Melbourne you are in easy distance to Melbourne Zoo, Flemington Racecourse, the MCG, the Museum, Crown Casino, Victorian Arts Centre, Queen Victoria Markets, Melbourne CBD, the National Gallery and all major hospitals including Royal Children's and Royal Woman's.

LYGON STREET RESTAURANT PRECINCT

Rydges North Melbourne is a short walk from the exciting Lygon Street district. Some of Melbourne's best Italian restaurants and cafés are located on Lygon Street in Carlton. Enjoy a walk down this exciting strip for a bowl of pasta, a great cup of coffee, or a simple Gelato.

THE DOCKLANDS AREA

The hotel is located within close proximity to the Docklands area. This fast emerging area is becoming the cosmopolitan centre of Melbourne. Docklands stadium, modern cafe's and new waterfront developments are springing up.

SOUTHBANK

On the southern side of the famous Yarra River lies the Southbank area. A boulevard filled with activity. Great shopping coupled with a fantastic selection of restaurants and bars ensures Southbank's reputation as a great entertainment venue. Crown Casino is Australia's premiere casino. Enjoy unique public areas with its waterfalls or enjoy a flutter on the many games. The Southbank area is a short taxi or tram ride from the hotel.

RACING IN MELBOURNE

Rydges North Melbourne is a short distance from both Moonee Valley and Flemington race tracks. The famous Melbourne Spring Carnival begins in late September and goes through until the end of November. See thoroughbreds from Australia, New Zealand and even Europe compete in the biggest races of the Australian racing calendar, including the Caulfield Cup, Cox Plate, Oaks day and the world famous Melbourne Cup.

AFL FOOTBALL

During the winter months the AFL Football is on in a big way in Melbourne. Telstra Dome and the MCG are both minutes from the property. Enjoy a fantastic day or evening at the footy and watch them fly. Enquire about our fabulous footy packages.

QUEEN VICTORIA MARKET

The Queen Victoria Market is on the corner of Victoria and Elizabeth Streets. Spend a day enjoying the variety of food, fashion, cafés, crafts and a fantastic atmosphere.

Pick up a bargain or simply enjoy a day in the sun. Your trip to Melbourne would not be the same without a visit to Melbourne's own Queen Victoria Market.

HOW TO GET THERE

When leaving Tullamarine Airport take the City Link exit at Flemington Road. Rydges North Melbourne is located on the corner of Flemington Road and Harker Street. The hotel is approximately 20 minutes drive from the airport.

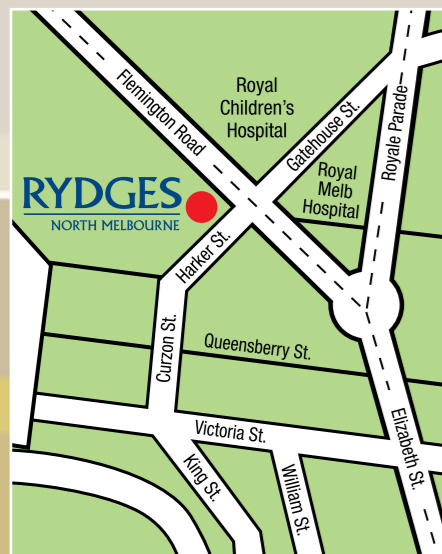

RYDGES

NORTH MELBOURNE

Cnr Flemington Road & Harker Street,
North Melbourne VIC 3051
Phone: 03 9329 1788
Fax: 03 9329 9950
Email: reservations_northmelbourne@rydges.com
Internet: www.rydges.com/northmelbourne

MEETING FACILITIES

CONFERENCES • BANQUETS • WEDDINGS

Cnr Flemington Road & Harker Street,
North Melbourne VIC 3051
Phone: 03 9329 1788
Fax: 03 9329 9950
Email: reservations_northmelbourne@rydges.com
Internet: www.rydges.com/northmelbourne



CONFERENCE ROOM CONFIGURATIONS

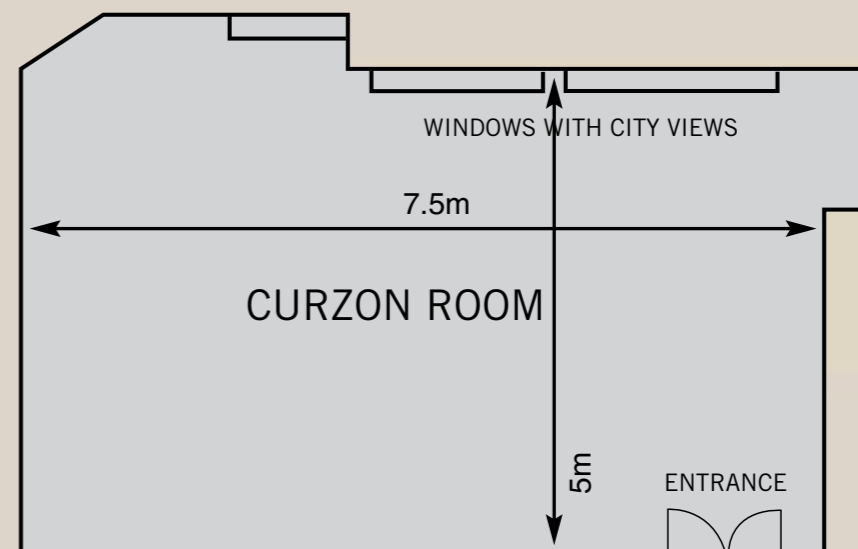
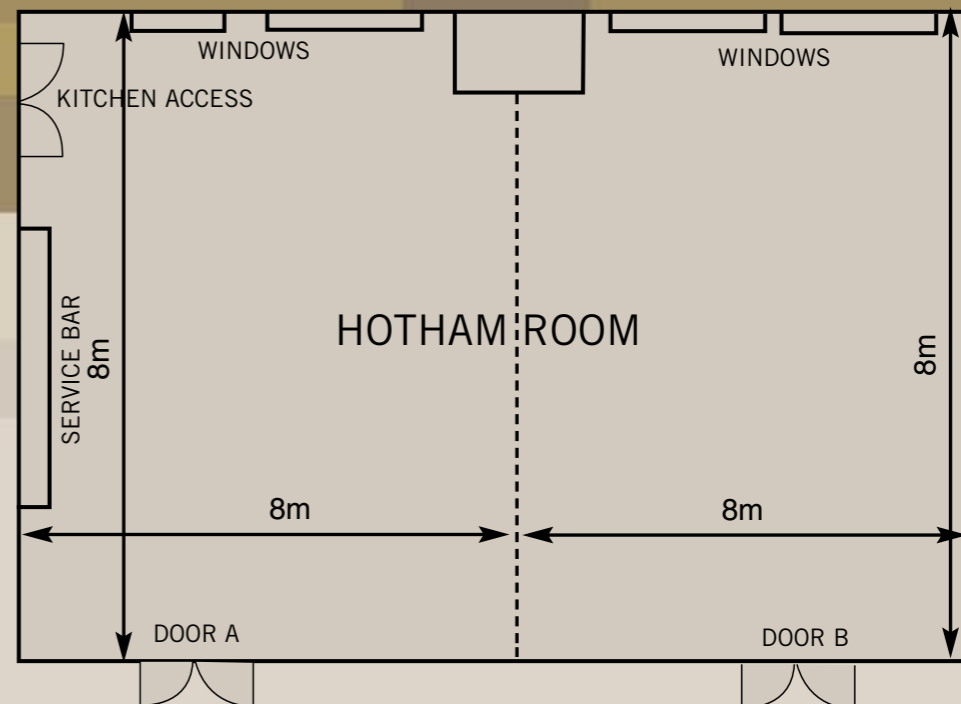

Rydges North Melbourne, conveniently located close to the Melbourne CBD, is simple, fresh and stylish. As you step inside the hotel the minimalist lines and earthy toned suede furnishings welcome guests. The hotel is the closest Rydges property to the Melbourne International Airport with facilities including Polo Café and Bar, an out door pool, three conference rooms bathed in natural light and ample undercover parking.

With your imagination and the assistance of our team, we can transform the conference and hotel spaces into unique environments, complete with brilliantly conceived and executed menus and décor.

There is a range of conference and meeting rooms that cater for a small meeting of 3 people to a conference for 140 delegates.

The Hotham Room offers great flexibility with its ability to be divided into two syndicate rooms or combined as one major room. Plus, with its full service built in bar, you can easily turn your meeting into a cocktail function.

All rooms have brilliant natural light - with the Hotham Room featuring a unique rock garden, pond and water cascade providing a relaxing and calm working environment.

The Curzon Room has direct views of the Melbourne CBD featuring a unique layout ideally suited to small presentations and meetings.

The registration alcove area and the Polo Bar are ideal for your post function breakout or pre-dinner drinks.

A full range of audio visual and technical equipment is available.

There are also an extensive range of catering options possible including day packages and residential conference packages.

CONFERENCE FEATURES

- Natural light and air-conditioned conference rooms
- State-of-the-art audio visual equipment
- In-room telephones and modem points
- Personal conference concierge service
- Professional audio visual technicians available
- Broadband & wireless internet available

HOTEL FEATURES

Features

- 1.6km from the city of Melbourne
- 17km from Melbourne International Airport
- Broadband & wireless internet available

HOTEL AND ROOM FACILITIES

- 70 guest rooms including two spa suites
- Outdoor swimming pool and sauna
- Non smoking rooms
- 24 room service
- Complimentary undercover car parking
- 24 hour reception
- Safe deposit
- Laundry and valet service

DINING CONCEPTS

POLO CAFE AND BAR

Delicious modern Australian cuisine in a stylish yet comfortable setting.



ROOM	CEILING HEIGHT	AREA(sq/m)	THEATRE	U-SHAPE	BOARD ROOM	CLASS-ROOM	COCKTAILS (STANDARD)	BANQUET (SET DOWN)
Hotham Room A	2.83	64	55	22	25	24	70	40
Hotham Room B	2.83	64	55	22	25	24	70	40
Hotham Rooms Combined	2.83	127	140	36	40	45	150	90
Curzon Room	2	32	30	15	18	18	35	20